

MT42FN

High torque 4.2” (110 mm) flange step motors

Specification		MT42FN39		MT42FN59	MT42FN79	
		075x8yy	100x8yy	110x8yy	070x8yy	110x8yy
Phase voltage	<i>Vdc</i>	2.70	2.50	3.30	4.62	3.08
Phase current	<i>A</i>	7.50	10.00	11.00	7.00	11.00
Phase resistance	<i>Ohm ±10%</i>	0.36	0.25	0.30	0.66	0.28
Phase inductance	<i>mH ±10%</i>	3.00	1.90	2.90	7.70	3.20
Bipolar holding torque	<i>Nm ±10%</i>	11.50		22.00	30.00	
Rotor inertia	<i>g.cm²</i>	5500		10900	16200	
Detent torque	<i>Nm</i>	0.30		0.59	0.75	
Max. radial force	<i>N</i>			300		
Max. axial force	<i>N</i>			80		
Step angle				1.8° ±5%		
Front shaft diameter	<i>mm</i>			19.05		
Rear shaft diameter (on request)				6.35		
Terminal or lead wires				8 lead wires of 400 mm		
Protection				IP30 (IP54 for motor with terminal box option)		
Ambient temperature	<i>°C</i>			- 40 ~ + 55		
Insulation class	<i>°C</i>			B, 130		
Dimensions	<i>mm</i>	110 x 110 x 99		110 x 110 x 150	110 x 110 x 201	
Weight	<i>Kg</i>	5.00		8.40	11.64	

x = M (single shaft) or B (double shaft).
yy = see available options lists.

MT42FN

Mechanical drawing:

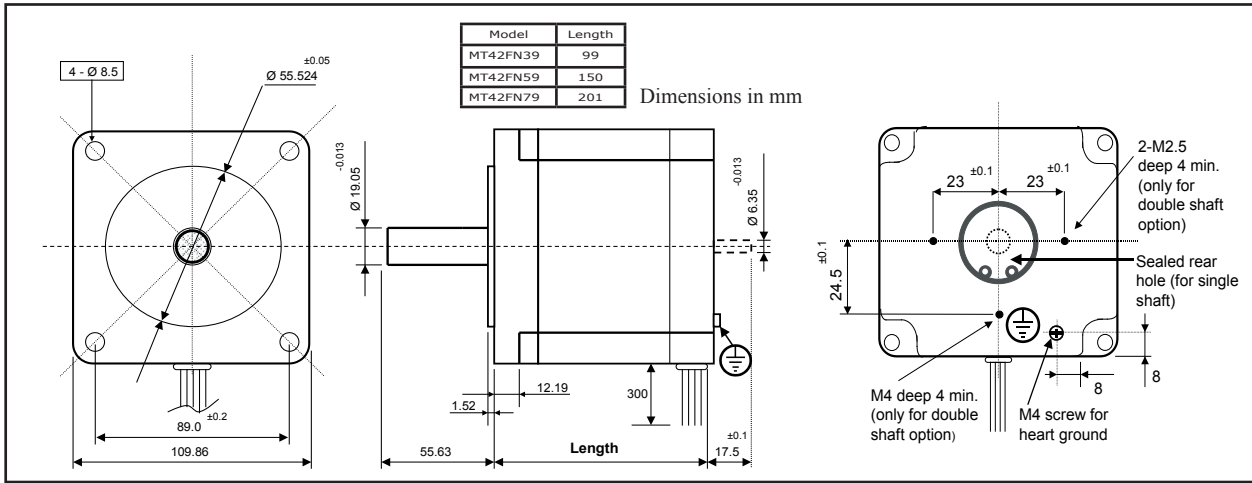

Connection diagram and torque diagrams:

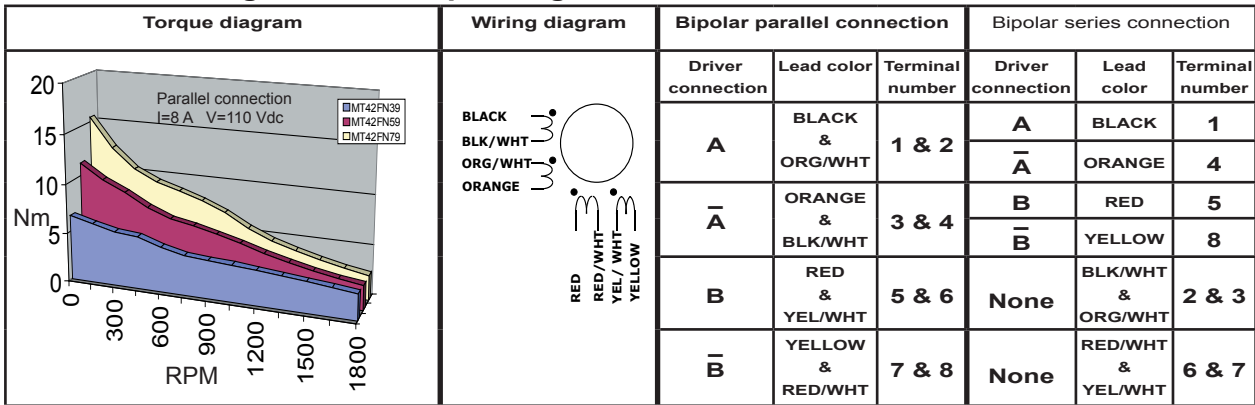

Options:

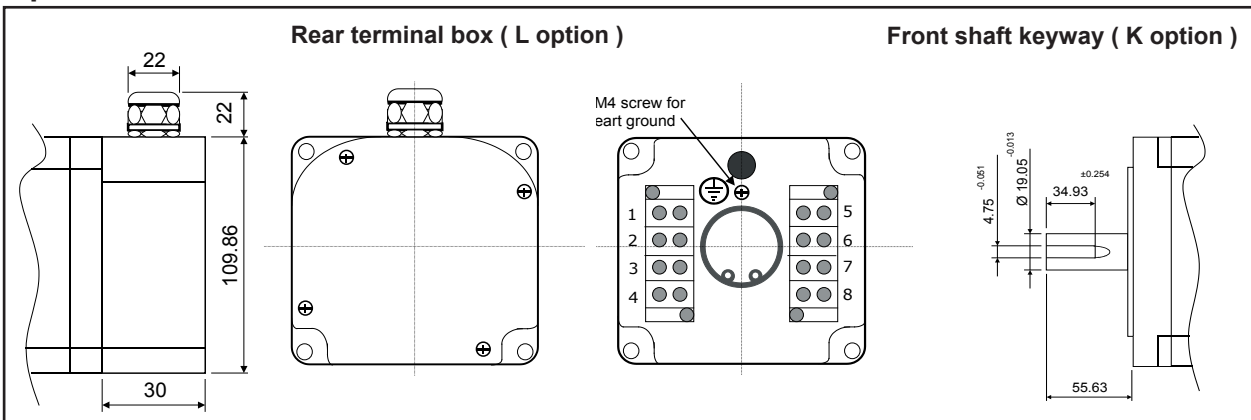

EVER SNC DI ING. CALDI & C.
 Via del Commercio, 2/4
 Loc. San Grato, Z.I. - 26900 LODI (ITALY)
 Tel. ++39 0371 412318 - Fax ++39 0371 412367
 e-mail : infoever@everelettronica.it
 web: www.everelettronica.it